

**"Your move is our motivation"**

**High Road, Chigwell, IG7  
Four Bedroom Detached Bungalow**

**Monthly Rental Of £3,495**



A beautifully refurbished and deceptively spacious four bedroom detached bungalow in the heart of Chigwell. A short walk to Chigwell's central line station, good schools, restaurants, shops and local amenities. The property has a spacious lounge / dining room which measures 20' 5" x 19' 11" in size. A newly fitted kitchen with integrated appliances with a separate utility / shower room. The master bedroom measures 13' 7" x 12' and bedroom two measures 14' 11" x 11' 11" in size. Bedroom three measures 12' x 8' 4" and bedroom four measures 15' 1" x 6' 6" in size. A modern family bathroom and an additional separate guest cloakroom in the hallway. The property has a large private rear garden with a paved patio, a lawn with plants and shrubs to the borders. To the front of the property there is a large carriage driveway with parking for numerous cars and attached garages.

- A beautifully refurbished deceptively spacious four bedroom detached bungalow in the heart of Chigwell
- A short walk to Chigwell's central line station, good schools, restaurants, shops and local amenities
- The property has a spacious lounge / dining room which measures 20' 5" x 19' 11" in size
- A newly fitted kitchen with integrated appliances with a separate utility / shower room
- The master bedroom measures 13' 7" x 12' and bedroom two measures 14' 11" x 11' 11" in size
- Bedroom three measures 12' x 8' 4" and bedroom four measures 15' 1" x 6' 6" in size

# Floor Plan

**Floor Plan**  
Approx. 178.7 sq. metres (1923.5 sq. feet)

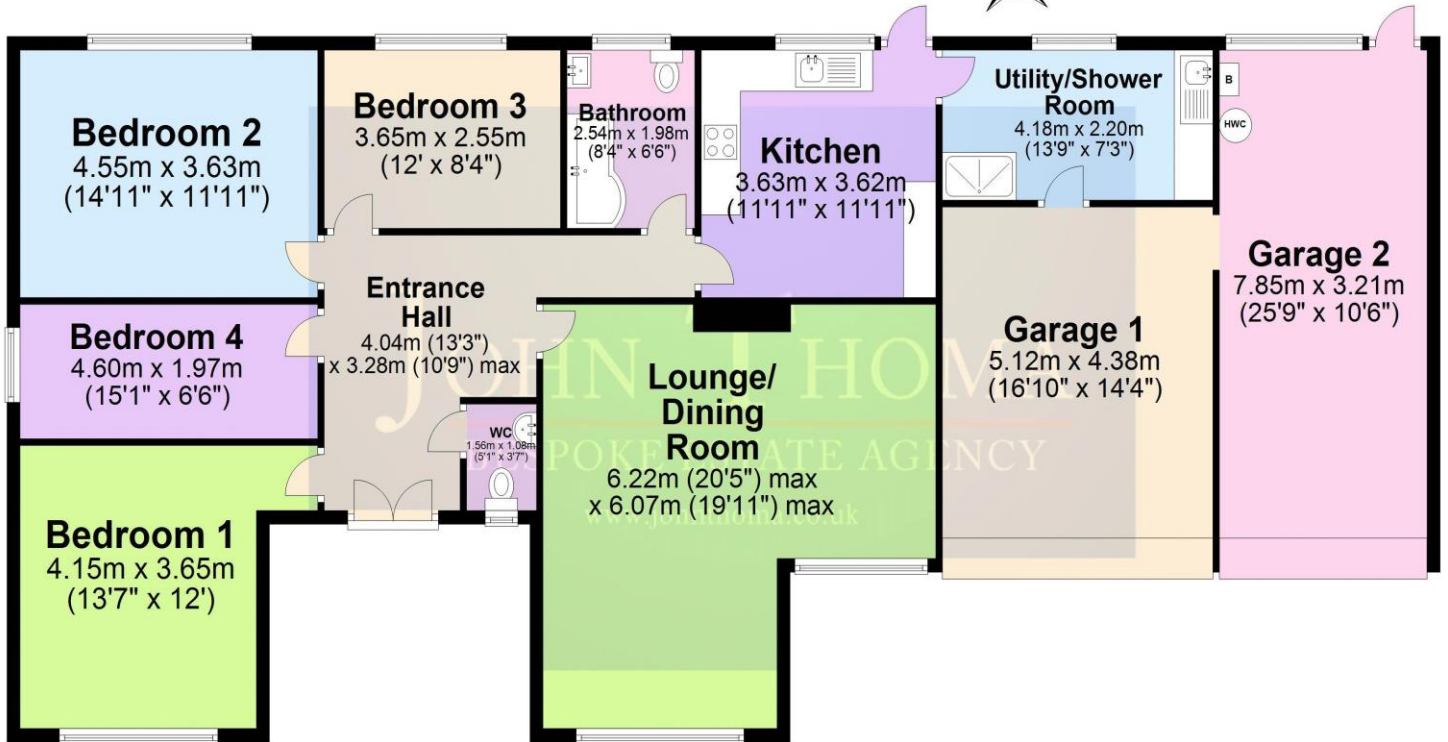

Total area: approx. 178.7 sq. metres (1923.5 sq. feet)

Illustrations are for viewing purposes only. Measurements are not to scale. Property Total and Floor Totals are internal figures only and do not include Balconies, Garden, Patios or Terraces if shown. Floor Area of any Outbuilding may be included in overall Total.  
Plan produced using PlanUp.